

		Section
CRESTA TRADITIONAL CLIPS,	Fig 1, 1ES	05
LIGHTWEIGHT CLIPS,	MÜPRO, crestalite, Talon	10
THREADED COMPONENTS	U Bolts, Reducers, Link eyes	15
INSULATION SUPPORT BLOCKS	Wood, Phenolic	20
ROLLERS, SLIDE GUIDES & ANCHORS		25
BRACKETS	Cantilever, Cleats, Gang Hangers	30
ACOUSTIC & VIBRATION ISOLATION PRODUCTS		31
STRUT SYSTEMS	Channel Sections and Accessories	35
FASTENERS & FIXINGS	Anchors, Purlin clips, Lindaptors	40
NUT BOLTS WASHERS		45
PLUMBING TUBE & FITTINGS	Tundishes, Dosing pots	50
TOOLS	Power tools, Hand tools, Hole saws	55
STEEL SECTIONS	Channel, Flat bar, Beams	60
SUNDRIES	Gloves, Tapes, Ancillaries, and Specials	65
FABRICATION	Bespoke Manufacture To Customer Designs	70
FIRE PROTECTION	Fire Collars, Wraps, Mastic	85
APPENDIX	Useful information	

THREADED COMPONENTS

Section 15

15

- This is a conventional range of products for all uses.
- Majority of items available from stock.
- Good traditional quality.
- Advice offered on which products are appropriate depending upon which medium is used i.e. copper or steel.

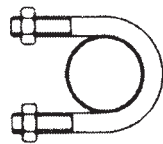

FIG 3-1503
U BOLT ANCHOR
(STEEL PIPE)

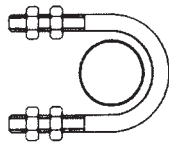

FIG 3A-1503A
U BOLT GUIDE
(STEEL PIPE)

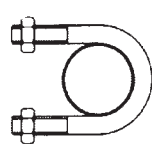

FIG 3B-1503B
BRASS U BOLT ANCHOR
(COPPER TUBE)

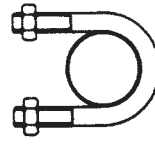

FIG 3BS-1503BS
U BOLT ANCHOR
BS 3974

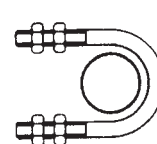

FIG 3C-1503C
BRASS U BOLT GUIDE
(COPPER TUBE)

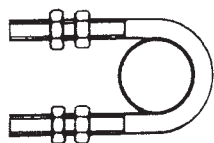

FIG 3D-1503D
EXTENDED LEG
U BOLT

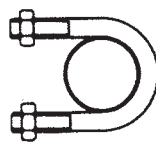

FIG 3S-1503S
STAINLESS STEEL
U BOLT ANCHOR



FIG 5-1505
DOUBLE THREAD ROD



FIG 5B-1505B
EYE ROD



FIG 5C-1505C
DOUBLE EYE ROD



FIG 5D-1505D
HOOK ROD



FIG 5E-1505E
ANCHOR BOLT

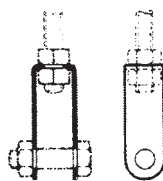

FIG 29-1529
LINK EYE



FIG 31-1531
PLATED ROD



FIG 41-1541
STUDDING

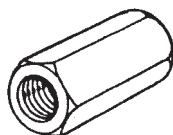

FIG 42-1542
HEXAGON
CONNECTOR

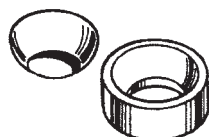

FIG 43-1543 & FIG 43A-1543A
HEMISPHERICAL
WASHER & CUP



FIG 44-1544
BRASS ROCKER NUT

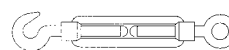

FIG 5F-1505F
TURNBUCKLE (HOOK & EYE)



FIG 5G-1505G
BOW NUT



MUPRO
ROUNDED CONNECTORS



MUPRO
HEX CONNECTORS



MUPRO
REDUCING CONNECTORS



MUPRO
REDUCERS



MUPRO
TURNBUCKLES



MUPRO
THREADED PINS WITH LEFT
AND RIGHT HANDS THREADS



MUPRO
SWIVEL HANGERS, SHORT



MUPRO
SWIVEL HANGERS, LONG

1503
'U' BOLT ANCHOR FOR STEEL PIPE / FIG 3

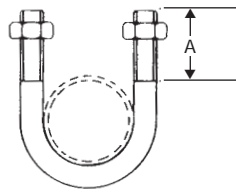

Part No.	Nominal Pipe Bore		Rod Dia.	A
	mm	inches		
0306015Z	15	1/2	6*	30
0306020Z	20	3/4	6*	30
0310025Z	25	1	10**	30
0310032Z	32	1 1/4	10	35
0310040Z	40	1 1/2	10	35
0310050Z	50	2	10	35
0312065Z	65	2 1/2	12	35
0312080Z	80	3	12	35
0312100Z	100	4	12	35
0312125Z	125	5	12	35
0312150Z	150	6	12	50
0312175A	175	7	12	50
0316200A	200	8	16	50
0316225A	225	9	16	50
0316250A	250	10	16	50
0316300A	300	12	16	50

Standard finish: up to 150mm zinc plated, over 150mm self colour.
Also available nylon coated. BZP or red oxide over 150 mm.
Other sizes and specification to order.

* available in 8mm.
**available in 6mm and 8mm.

1503A
'U' BOLT GUIDE FOR STEEL PIPE / FIG 3A

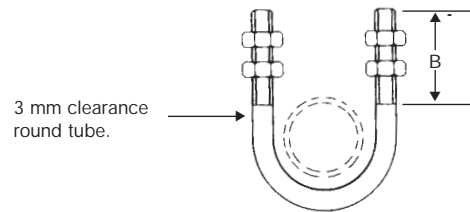

Part No.	Nominal Pipe Bore		Rod Dia.	B
	mm	inches		
03A0015Z	15	1/2	6	40
03A0020Z	20	3/4	6	40
03A0025Z	25	1	10	40
03A0032Z	32	1 1/4	10	40
03A0040Z	40	1 1/2	10	40
03A0050Z	50	2	10	40
03A0065Z	65	2 1/2	12	50
03A0080Z	80	3	12	50
03A0100Z	100	4	12	50
03A0125Z	125	5	12	50
03A0150Z	150	6	12	50
03A0175Z	175	7	12	65
03A0200Z	200	8	16	65
03A0225Z	225	9	16	65
03A0250Z	250	10	16	65
03A0300Z	300	12	16	65

Standard finish: up to 150mm: zinc plated, over 150mm: self colour.
3mm clearance around the tube.
Also available nylon coated, galvanised. BZP or red oxide over 150mm.
Other sizes and specification to order.

15

1503B
BRASS 'U' BOLT ANCHOR FOR COPPER TUBE / FIG 3B

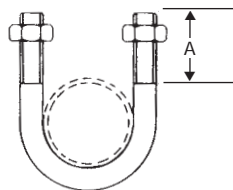

Part No.	Tube Size	Rod Dia.	A	Poly Strip Part No.
	mm			
03B0015B	15	6	35	03BP015P
03B0022B	22	6	35	03BP022P
03B0028B	28	6	35	03BP028P
03B0035B	35	6	35	03BP035P
03B0042B	42	6	35	03BP042P
03B0054B	54	6	35	03BP054P
03B0067B	67	8	40	03BP067P
03B0076B	76	8	40	03BP076P
03B0108B	108	8	40	03BP108P
03B0133B	133	10	40	03BP133P
03B0159B	159	10	40	03BP159P

Also available in nylon coated steel.

1503C
BRASS 'U' BOLT GUIDE FOR COPPER TUBE / FIG 3C

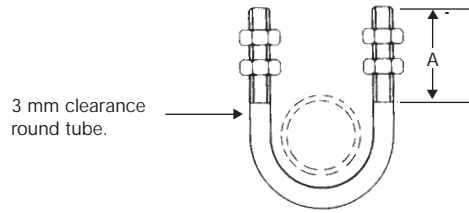

Part No.	Tube Size mm	Rod Dia mm	A mm	Poly Strip Part No.
03C0015B	15	6	35	03CP015P
03C0022B	22	6	35	03CP022P
03C0028B	28	6	35	03CP028P
03C0035B	35	6	35	03CP035P
03C0042B	42	6	35	03CP042P
03C0054B	54	6	35	03CP054P
03C0067B	67	8	40	03CP067P
03C0076B	76	8	40	03CP076P
03C0108B	108	8	40	03CP108P
03C0133B	133	10	40	03CP133P
03C0159B	159	10	40	03CP159P

Also available in nylon coated steel.
3mm clearance around tube.

1503BS
'U' BOLT ANCHOR / FIG 3BS

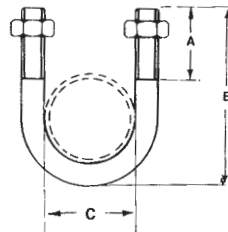

Roll thread 'U' bolts to BS 3974 dimensions

Part No.	Nominal Pipe Size		Rod Dia mm	A mm	B mm	C mm
	mm	inches				
03BS015Z	15	1/2	8	25	46	22
03BS020Z	20	3/4	8	25	56	27
03BS025Z	25	1	8	25	61	37
03BS032Z	32	1 1/4	8	25	71	47
03BS040Z	40	1 1/2	10	35	85	50
03BS050Z	50	2	10	35	95	65
03BS065Z	65	2 1/2	12	45	124	75
03BS080Z	80	3	16	50	142	89
03BS100Z	100	4	16	50	167	119
03BS125Z	125	5	16	50	192	144
03BS150Z	150	6	20	55	225	170

Standard finish: Zinc plated
Larger sizes to order

1503D
EXTENDED LEG 'U' BOLT FOR STEEL PIPE / FIG 3D

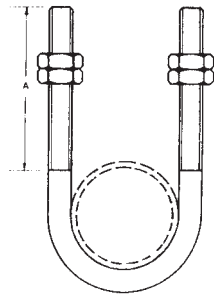

For use with Gang Hangers

Part No.	Nominal Pipe Bore		Rod Dia.	A
	mm	inches	mm	mm
03D0015Z	15	1/2	6	75
03D0020Z	20	3/4	6	75
03D0025Z	25	1	10	75
03D0032Z	32	1 1/4	10	85
03D0040Z	40	1 1/2	10	85
03D0050Z	50	2	10	85
03D0065Z	65	2 1/2	12	85
03D0080Z	80	3	12	90
03D0100Z	100	4	12	90
03D0125Z	125	5	12	90
03D0150Z	150	6	12	90

Standard finish: zinc plated
Also available nylon coated, galvanised.
Other sizes and specifications to order.

1503S
'U' BOLT ANCHOR FOR STAINLESS STEEL PIPE / FIG 3S

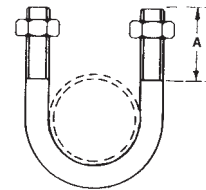

For use with Gang Hangers

Part No.	Nominal Pipe Bore		Rod Dia.	A
	mm	inches	mm	mm
03S0015S	15	1/2	6	30
03S0020S	20	3/4	6	30
03S0025S	25	1	6	30
03S0032S	32	1 1/4	10	40
03S0040S	40	1 1/2	10	40
03S0050S	50	2	10	40
03S0065S	65	2 1/2	10	40
03S0080S	80	3	12	40
03S0100S	100	4	12	40
03S0125S	125	5	12	40
03S0150S	150	6	12	50

Material grade 316 stainless steel.
Larger sizes to order

1505
DOUBLE THREAD ROD / FIG 5

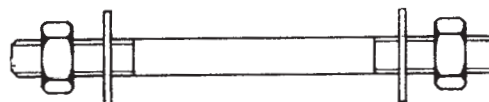

Diameter M10		Diameter M12		Diameter M16	
Length	Part No.	Length	Part No.	Length	Part No.
mm		mm		mm	
150	0503150A	150	0504150A	150	0505150A
225	0503225A	225	0504225A	225	0505225A
300	0503300A	300	0504300A	300	0505300A
375	0503375A	375	0504375A	375	0505375A
450	0503450A	450	0504450A	450	0505450A
525	0503525A	525	0504525A	525	0505525A
600	0503600A	600	0504600A	600	0505600A
675	0503675A	675	0504675A	675	0505675A
750	0503750A	750	0504750A	750	0505750A
900	0503900A	900	0504900A	900	0505900A

Standard finish: self colour.
Other diameters and lengths to order.
All threads 75mm long, with nut and washer.
Extended thread lengths to order.
Also available zinc plated.

15

1505B
FORMED EYE ROD / FIG 5 B



Diameter M10		Diameter M12		Diameter M16	
Length	Part No.	Length	Part No.	Length	Part No.
mm		mm		mm	
150	05B3150A	150	05B4150A	150	05B5150A
225	05B3225A	225	05B4225A	225	05B5225A
300	05B3300A	300	05B4300A	300	05B5300A
375	05B3375A	375	05B4375A	375	05B5375A
450	05B3450A	450	05B4450A	450	05B5450A
525	05B3525A	525	05B4525A	525	05B5525A
600	05B3600A	600	05B4600A	600	05B5600A
675	05B3675A	675	05B4675A	675	05B5675A
750	05B3750A	750	05B4750A	750	05B5750A
900	05B3900A	900	05B4900A	900	05B5900A

Standard finish: self colour.
 Other diameters and lengths to order.
 All threads 75mm long, with nut and washer.
 Extended thread lengths to order.
 Also available zinc plated.
 Eyes can be supplied welded.

1505C
DOUBLE EYE ROD / FIG 5C



Diameter M10		Diameter M12		Diameter M16	
Length	Part No.	Length	Part No.	Length	Part No.
mm		mm		mm	
150	05C3150A	150	05C4150A	150	05C5150A
225	05C3225A	225	05C4225A	225	05C5225A
300	05C3300A	300	05C4300A	300	05C5300A
375	05C3375A	375	05C4375A	375	05C5375A
450	05C3450A	450	05C4450A	450	05C5450A
525	05C3525A	525	05C4525A	525	05C5525A
600	05C3600A	600	05C4600A	600	05C5600A
675	05C3675A	675	05C4675A	675	05C5675A
750	05C3750A	750	05C4750A	750	05C5750A
900	05C3900A	900	05C4900A	900	05C5900A

Standard finish: self colour.
 Other diameters and lengths to order.
 Eyes can be supplied welded.
 Also available zinc plated.

1505D
HOOK ROD / FIG 5D



Diameter M10		Diameter M12		Diameter M16	
Length	Part No.	Length	Part No.	Length	Part No.
mm		mm		mm	
150	05D3150A	150	05D4150A	150	05D5150A
225	05D3225A	225	05D4225A	225	05D5225A
300	05D3300A	300	05D4300A	300	05D5300A
375	05D3375A	375	05D4375A	375	05D5375A
450	05D3450A	450	05D4450A	450	05D5450A
525	05D3525A	525	05D4525A	525	05D5525A
600	05D3600A	600	05D4600A	600	05D5600A
675	05D3675A	675	05D4675A	675	05D5675A
750	05D3750A	750	05D4750A	750	05D5750A
900	05D3900A	900	05D4900A	900	05D5900A

Standard finish: self colour.
Other diameters and lengths to order.
All threads 75mm long, with nut and washer.
Extended thread lengths to order
Also available zinc plated.

15

1505E
ANCHOR BOLT / FIG 5E ROD



Diameter M10		Diameter M12		Diameter M16	
Length	Part No.	Length	Part No.	Length	Part No.
mm		mm		mm	
150	05E3150A	150	05E4150A	150	05E5150A
225	05E3225A	225	05E4225A	225	05E5225A
300	05E3300A	300	05E4300A	300	05E5300A
375	05E3375A	375	05E4375A	375	05E5375A
450	05E3450A	450	05E4450A	450	05E5450A
525	05E3525A	525	05E4525A	525	05E5525A
600	05E3600A	600	05E4600A	600	05E5600A
675	05E3675A	675	05E4675A	675	05E5675A
750	05E3750A	750	05E4750A	750	05E5750A
900	05E3900A	900	05E4900A	900	05E5900A

Standard finish: self colour.
Other diameters and lengths to order.
All threads 75mm long, with nut and washer.
Extended thread lengths to order.
Also available zinc plated.

1529
LINK EYE / FIG 29

Part No.	Size No.	A	B	C	D
		mm	mm	mm	mm
2900002A	2	16	40	25	M10
2900003A	3	22	50	25	M12
2900004A	4	26	60	50	M16

Standard finish:

- Size 2+3 Pre galvanised material (Zinctec)
- Size 4 Red oxide (also available galvanised)
- Size 2,3+4 Also available in stainless steel

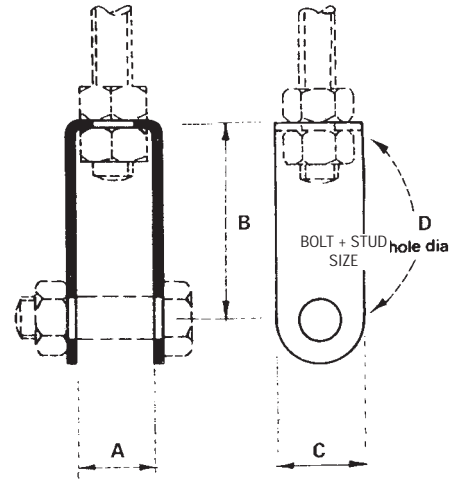

1531
PLATED ROD / FIG 31

Part No.	Size No	B
A = 70 x 70 x 6		
3100001A	1	M 10
3100002A	2	M 12
3100003A	3	M 16

Part No.	Size No	B
A = 100 x 100 x 6		
3100004A	4	M 10
3100005A	5	M12
3100006A	6	M16

Standard finish: Red Oxide

Also available BZP
Other sizes plates, threads and rod lengths to order.

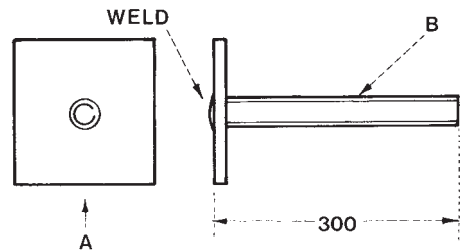

MÜPRO round connectors, for joining or connecting threaded items zinc plated



Part No.	Thread	Length	Outer diameter	Pack size [piece]
		mm	mm	
14567	M6	20	10	100
14575	M6	30	10	100
14583	M6	40	10	100
14591	M6	50	10	100
14565	M8	20	11	100
14664	M8	30	11	100
14672	M8	40	11	100
14680	M8	50	11	100
22292	M10	30	13	100
24805	M10	40	13	100
27138	M12	30	15	100
23302	M12	40	15	100
23639	M12	55	15	100
23299	M16	40	22	50

MÜPRO hex connectors, with site hole for checking insertion depth (for M8 to M12) zinc plated



Part No.	Thread	Length	Spanner width	Pack size [piece]
		mm	mm	
21490	M8	30	13	100
21504	M10	30	17	100
21512	M12	35	17	50
20826	M16	50	24	50

MÜPRO round connectors, for joining or connecting threaded items zinc plated



Part No.	Thread	Length	Outer diameter	Pack size [piece]
		mm	mm	
21515	M6/M8	30	spanner width 13	100
21520	M8/M10	40	17	100
21539	M8/M12	40	17	100
21547	M10/M12	40	17	100

MÜPRO reducers, zinc plated



Part No.	Male Thread	Female Thread	Spanner width	Pack size [piece]
		mm	mm	
29513	M6	M8	13	100
37966	M6	M10	13	100
21989	M8	M6	13	100
21970	M8	M10	13	100
26697	M8	M12	17	100
37958	M10	M6	13	100
26700	M10	M8	13	100
29521	M10	M12	17	100
23329	M10	M16	24	50
29548	M12	M8	13	100
37672	M12	M10	12	100
23310	M12	M16	24	50
23337	M16	M10	19	50
23345	M16	M12	19	50

MÜPRO Turnbuckles, with left and right hand threads with safety sight holes zinc plated



Part No.	Connection Thread	Overall length	Adjustment range	Pack size [piece]
		mm	mm	
37915	M8	50	30	100
37923	M10	60	40	50
37931	M12	70	50	50
37939	M16	170	120	25

MÜPRO threaded pins with left and right hand threads, for use with turnbuckles, zinc plated

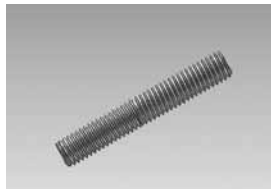

Part No.	Connection Thread	Length	Pack size [piece]
		mm	mm
35165	M8	50	100
35157	M10	60	100
28932	M12	70	100
28738	M12	150	100
28742	M16	210	50

15

MÜPRO Swivel Hangers, short



Part No.	Connection Thread	Overall length	Thread length	Angular movement	Pack size
		mm	mm		
39888	M8	34	14	up to 12°	100
39896	M10	35	17	up to 12°	50

360° degree of freedom
zinc plated
(please refer to: 'Anchor and Expansions Assemblies' chapter)

15

MÜPRO Swivel Hangers, long



Part No.	Connection Thread	Overall length	Thread length	Angular movement	Max. height adjustment	Pack size
		mm	mm		mm	
12041	M8	60	14	up to 12°	25	50
12068	M10	61	17	up to 12°	25	50
87090	M10	61	17	up to 22°	25	50
13188	M10	61	57	up to 12°	25	50
12165	M12	70	19	up to 12°	25	50

360° degree of freedom
with safety sight holes
zinc plated
(please refer to: 'Anchor and Expansions Assemblies' chapter)

1542
HEXAGON CONNECTOR / FIG 42

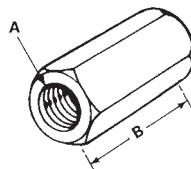

Part No.	'A' Thread	B mm
	mm	mm
4200001A	M6	18
4200002A	M8	24
4200003A	M10	30
4200004A	M12	36
4200005A	M16	40
4200006A	M20	60
4200007A	M24	72

Standard finish: Self colour.
Also available zinc plated.

1541
STUDDING (ALL THREAD) / FIG 41

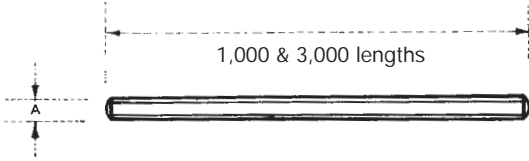

Part No.	'A' Thread		Length
	mm	mm	
TRM06X1Z	M6		1
TRM06X2Z	M6		2
TRM06X3Z	M6		3
TRM08X1Z	M8		1
TRM08X2Z	M8		2
TRM08X3Z	M8		3
TRM10X1Z	M10		1
TRM10X2Z	M10		2
TRM10X3Z	M10		3
TRM12X1Z	M12		1
TRM12X2Z	M12		2
TRM12X3Z	M12		3
TRM16X1Z	M16		1
TRM16X2Z	M16		2
TRM16X3Z	M16		3
TRM20X1Z	M20		1
TRM20X2Z	M20		2
TRM20X3Z	M20		3
TRM24X1Z	M24		1

Standard finish: Zinc plated.
Also available Brass, Stainless steel
Available from stock in 1 metre and 3 metre lengths
Other lengths available to order.

1544A
STEEL ROCKER NUT / FIG 44A

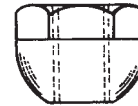

Part No.	Size
44A0001A	M6
44A0002A	M8
44A0003A	M10
44A0004A	M12
44A0005A	M16
44A0006A	M20

Standard finish: Self colour.
Also available zinc plated.

PLEASE CONTACT OUR SALES OFFICE FOR PRICES

1544
BRASS ROCKER NUT / FIG 44

Part No.	Size
4400001Z	M6
4400002Z	M8
4400003Z	M10
4400004Z	M12
4400005Z	M16
4400006Z	M20

PLEASE CONTACT OUR SALES OFFICE FOR PRICES

1543
HEMISPHERICAL WASHER / FIG 43



Part No.	Size
4300001Z	M6
4300002Z	M8
4300003Z	M10
4300004Z	M12
4300005Z	M16
4300006Z	M20
4300007Z	M24

Standard finish: zinc plated.

ALSO AVAILABLE - WELDLESS EYE NUTS/ WELDING BOSSES/ REDUCERS/
FORGED EYE BOLTS

PLEASE CONTACT OUR SALES OFFICE FOR PRICES AND DETAILS

1543A
HEMISPHERICAL CUP / FIG 43A

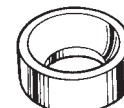
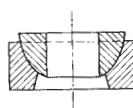

Part No.	Size
43A0003Z	M10
43A0004Z	M12
43A0005Z	M16
43A0006Z	M20
43A0007Z	M24

Standard finish: zinc plated.

1505F
TURNBUCKLE (HOOK & EYE) / FIG 5F

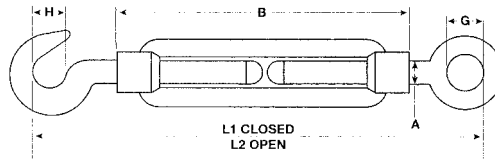

Part No.	Dimensions						Weight
	A	B	L1	L2	G	H	
	mm	mm	mm	mm	mm	mm	kgs/each
TBHE 0052	5	80	115	170	7	8	0.05
TBHE 0062	6	85	123	188	9	8	0.08
TBHE 0082	8	105	155	235	10	9	0.15
TBHE 0102	10	125	185	280	13	12	0.25
TBHE 0122	12	138	215	320	16	15	0.35

Standard finish: zinc plated
Also available Eye and Eye

1505G
BOW NUT / FIG 5G

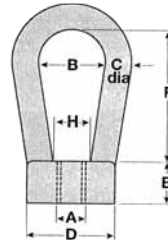

Part No.	Dimensions							Weight	SWL
	A	B	C	D	E	F	H		
	mm	mm	mm	mm	mm	mm	mm	kgs/each	tonnes
BOW0006Z	M6	25	10	32	16	38	18	0.20	0.23
BOW0008Z	M8	25	10	32	16	38	18	0.20	0.23
BOW0010Z	M10	25	10	32	16	38	18	0.20	0.36
BOW0012Z	M12	30	12	38	18	43	20	0.30	0.53
BOW0016Z	M16	30	12	38	18	43	20	0.30	1.01
BOW0020Z	M20	40	14	45	25	63	25	0.60	1.58
BOW0022Z	M22	50	17	50	28	79	30	0.60	1.93
BOW0024Z	M24	50	17	50	28	79	30	0.90	2.28
BOW0030Z	M30	75	26	70	38	82	46	2.40	3.65
BOW0033Z	M33	75	26	70	38	82	46	2.40	4.49
BOW0036Z	M36	75	26	70	38	82	46	2.40	5.34
BOW0042Z	M42	100	30	80	45	105	59	3.00	7.40

Standard finish: zinc plated
Also available tested and certified.